

BAS-365H-05AV

700mm x 400mm

BAS-370H-050V

700mm x 700mm

Bridge Type Programmable Electronic Pattern Sewer
with Vertical Shaft Rotary Hook Specification.

- The perfect stitch area has been expanded.
- Rotary digital tension is equipped as standard to achieve more textured stitches on leather and car seat products.
- The needle hole plunger mechanism reduces thread loss at the beginning of sewing and stabilizes thread tightening.
- Independent thread trimmer by pulse motor allows longer upper and lower thread lengths after thread trimming.



•Vertical Shaft Rotary Hook

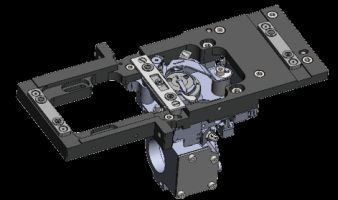

•Example



NEXIO

Specifications/

BAS-365H-05AV

BAS-370H-050V

	BAS-365H-05AV	BAS-370H-050V
Stitch form	Single needle lock stitch	
Hook	Vertical shaft rotary hook	
Max. sewing speed	2,000sti/min	
Max. sewing area(W×D)	700mm×400mm	700mm×700mm
Machine's footprint	1,699mm×1,296mm	1,699mm×2,076mm
Feed mechanism	Intermittent feed (pulse motor drive)	
Stitch length	0.05-20.0mm (per 0.05mm)	
Max. number of stitches	100,000 stitches (per program)	
Max. number of programs	999	
Work clamp lift amount	Max.52.5mm	—
Work clamp	Pneumatic work clamp	—
Height of stepping presser foot	24mm (highest needle stop position)	
Stepping presser foot stroke	0-10mm (per 0.1mm)	
Head lifting function	Standard equipment	
Head lift amount	70mm(height from the top of the auxiliary plate Max.95mm)	
Needle cooler	Standard equipment	
Thread wiper	Standard equipment	
Upper thread tension system	Digital rotary tension	
Thread breakage detection	Standard equipment (fiber sensor drive)	
Skipped stitch detection	Optional (upper thread tension sensing type)*1	
Data storage media	Internal flash memory (data addition is available with external memory)	
Motor	AC servo motor 550W	
Weight	Approx.640kg	Approx.810kg
Power	Single phase 220V / 230V 3-phase 200V / 220V	
Apparent power / Power consumption	1200VA / 590Wh	1200VA / 700Wh
Air pressure/Consumption	0.5MPa / Needle cooler ON : 8l/min OFF : 0.2l/min	

Optional Parts/

*1 SEW-DEFECT DETECTION DEVICE L <SC3414201>

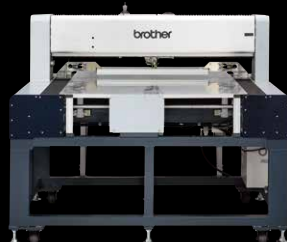

Facebook



Brother GT/ISM Support App



RoHS Compliant

BAS-365H,BAS-370H is compliant with the RoHS Directive(the restriction of the use of certain hazardous substances in electrical and electronic equipment) which came into effect in the EU in July 2006.

Please read instruction manual before using the machine for safety operation.

-Product specifications are subject to change for improvement without notice.

-Photographs are for illustration purpose. They may not represent actual operating conditions and may display optional parts.



Brother
Earth

Working with you for a better environment
www.brotherearth.com

CHINA

ASIA

EUROPE AFRICA, MIDDLE EAST

AMERICAS

BROTHER MACHINERY SHANGHAI LTD.

BROTHER MACHINERY (ASIA) LTD.

BROTHER INTERNATIONALE INDUSTRIEMASCHINEN GmbH

BROTHER INTERNATIONAL CORPORATION

<https://www.brother.cn/>

<https://www.brother.com.hk/>

<https://www.brother-ism.com/>

<https://www.brother-usa.com/>

+86-21-3135-3355

+852-2777-0010

+49-2822-6090

+1-908-704-1700



BROTHER INDUSTRIES, LTD.

1-5, Kitajizoyama, Noda-cho, Kariya-shi, Aichi 448-0803, Japan.

Phone: 81-566-95-0088 Fax: 81-566-25-3721 <https://industrialsewingmachine.global.brother/>

2024.03 I4031909Z Vol.1